

STATE  
LIBRARY  
OF NSW

# Venue information



STATE LIBRARY®  
NEW SOUTH WALES



## Acknowledgment of Country

The State Library of NSW offers our respect to Aboriginal Elders past and present, and extends that respect to other First Nations people. We celebrate the strength and diversity of NSW Aboriginal cultures, languages and stories.

The State Library of NSW is home to a variety of spectacular venue hire spaces available for your next event.

Located in the heart of Sydney's CBD, the State Library has venues to accommodate a diverse range of events, from small meetings to large workshops, presentations, cocktail parties, film screenings, hybrid events, weddings and more.

## Contact

Venue Hire, Visitor Services Branch  
State Library of NSW  
1 Shakespeare Place, Sydney NSW 2000  
(02) 9273 1744  
venue.hire@sl.nsw.gov.au  
sl.nsw.gov.au

The Mitchell building is the home of the iconic Mitchell Library Reading Room and Mitchell Vestibule; it houses the Library Auditorium, Glasshouse, the Friends, Gallery, Dixson and Shakespeare Rooms, along with our exciting permanent and featured exhibition galleries.

The Macquarie St building includes our Metcalfe Auditorium, Macquarie Room, Cafe Trim and Macquarie foyer, renowned for hosting popular author talks, scholarly events and corporate functions.

Venue	Price
Library Auditorium inc. Glasshouse	\$4500
Glasshouse*	\$4000
Dixson Room	\$2400
Shakespeare Room	\$1500
Friends Room*	\$2990
Gallery Room	\$3150
Map Rooms	
- The Michael Crouch Room	\$1500
Jean Garling Room	\$1500
Metcalfe Auditorium	\$2100
Macquarie Room	\$1500
Paintings Galleries*	\$4995
Mitchell Vestibule*	\$4500
Library Bar*	\$4000

Security fees will apply outside the Library's opening hours

\* conditions apply





# Library Auditorium

\$4500

## Capacity

tiered theatre seating 344

## Includes\*

- 2 green rooms
- 10 m x 4 m screen
- 4K RGB laser cinema projector
- CinemaScope capability
- surround sound
- lectern with microphone
- 2 wireless microphones
- Access to the Glasshouse for catering, registration and display

*\* Please note that an audiovisual technician is required to access some advanced services \$POA.*







# Glasshouse\*

\$4000

A large, light filled atrium adjoining the Library Auditorium.

## Capacity

cocktail 350

---

dinner round 210

---

## Includes

trestle tables

high bar tables

conference chairs

*\* conditions apply*





# Dixon Room

\$2400

## Capacity

cocktail	200
theatre	150
dinner round	120
cabaret	80
classroom	78
clusters	56
long dining	54
u-shape	51
boardroom	42

## Includes

- tables (trestle or dining)
- conference chairs
- stage
- data projector & screen
- laptop
- sound system
- lectern with microphone
- two handheld microphones
- laptop & clicker





# Shakespeare Room

\$1500

## Capacity

cocktail	15
theatre	15
boardroom	10
dinner round	10
cabaret	8

## Includes

- tables (trestle or dining)
- conference chairs
- LCD screen
- laptop & clicker





# Friends Room\*

\$2990

## Capacity

cocktail	150
theatre	120
dinner round	70
cabaret	56
long dining	54

## Includes

- tables (trestle or dining)
- lounge chairs
- conference chairs
- handheld microphone

\* conditions apply





# Gallery Room

\$3150

## Capacity

cocktail	200
theatre	150
dinner round	120
cabaret	80
clusters	80
long dining	60

## Includes

- tables (trestle or dining)
- conference chairs
- two 90" LCD screens
- stage
- lectern with microphone
- two handheld microphones
- laptop & clicker





# Map Rooms

## The Michael Crouch Room

\$1500

### Capacity

cocktail	45
theatre	40
clusters	28
boardroom	32
long dining	32

### Includes

- conference tables
- conference chairs
- data projector & screen
- laptop & clicker
- lectern with microphone







# Jean Garling Room

\$1500

### Capacity

boardroom	20
long dining	20

### Includes

- fixed boardroom table
- conference chairs
- LCD screen
- laptop & clicker





# Metcalfe Auditorium

\$2100

## Capacity

tiered auditorium seating	132
---------------------------	-----

## Includes

- tiered auditorium seating
- data projector & screen
- laptop & clicker
- lectern with microphone
- two handheld microphones

**Add** the Macquarie Room  
for catering space + \$800





# Macquarie Room

\$1500

## Capacity

cocktail	100
theatre	60
clusters	40
classroom	36
boardroom	36
u-shape	30

## Includes

trestle tables  
conference chairs  
2 x 75" LCD Screens  
laptop & clicker

## Add lectern

with microphone + \$450







# Galleries

## Paintings from the Collection

\$4995

More than 300 original artworks from the Library's unique collection of landscape and portrait paintings on permanent public display.

### Paintings Galleries\*

cocktail	350
long dining	150
dinner round	140

\* conditions apply



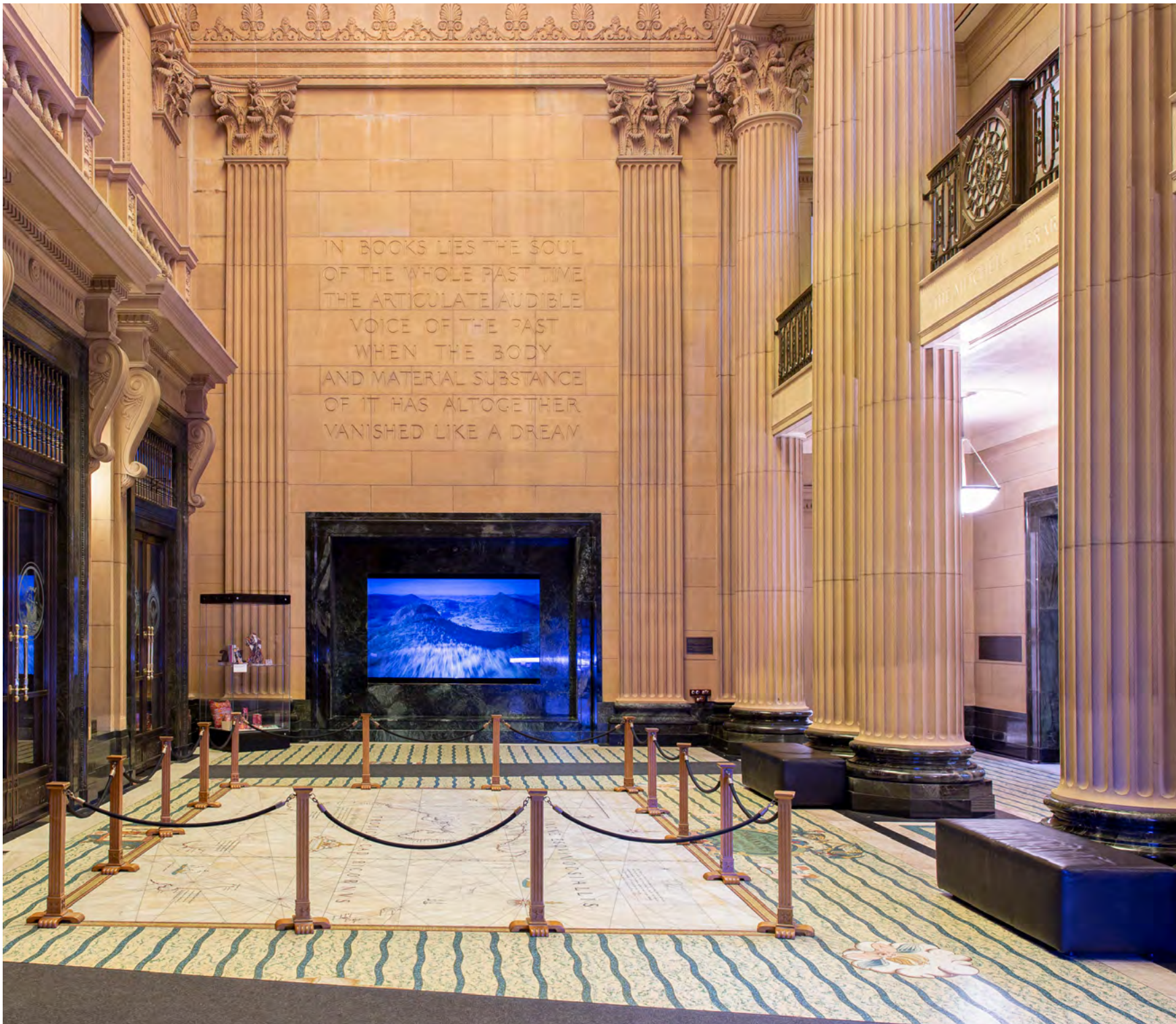

## Exhibition Galleries and Public Spaces

The Library's exhibition galleries and public spaces are available for hire outside of Library opening hours, subject to approval from the State Library of NSW.

For more information about our exhibition galleries and the use of public spaces, please contact our Venue Hire team directly via [venue.hire@sl.nsw.gov.au](mailto:venue.hire@sl.nsw.gov.au) or (02) 9273 1744.

<b>Mitchell Vestibule*</b>	<b>\$4500</b>
cocktail	150
dinner	70

*\* conditions apply*



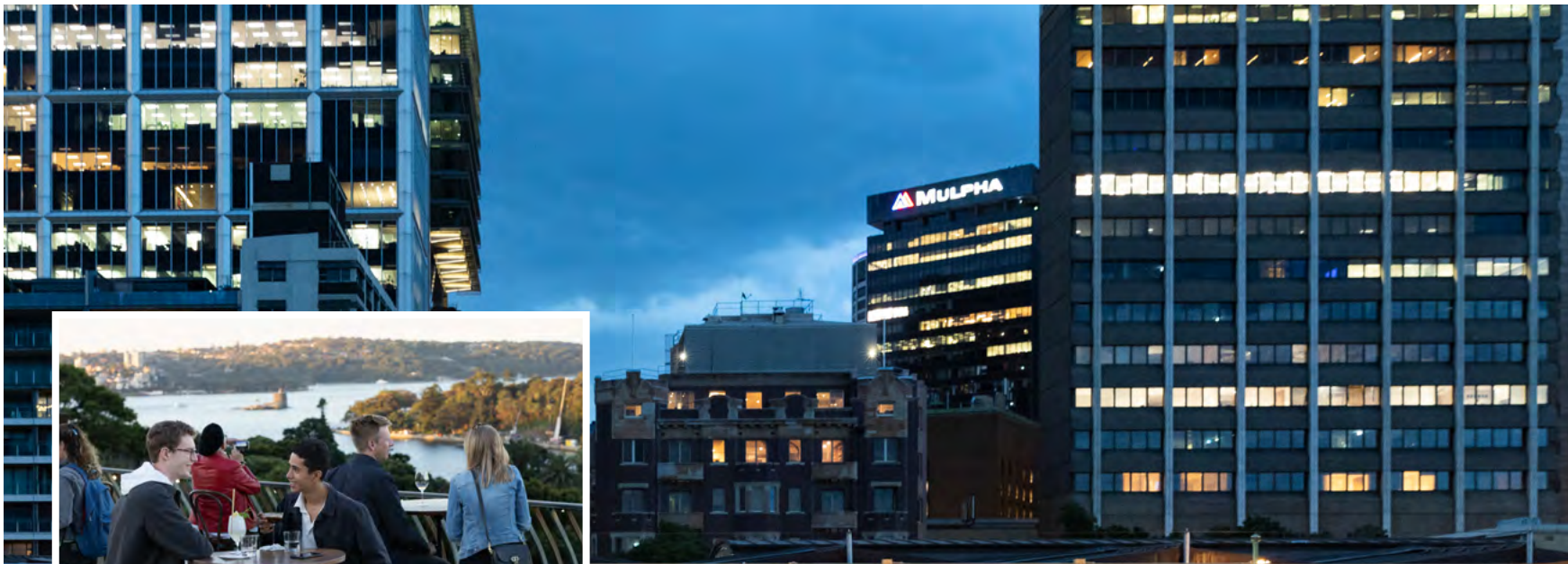

# Library Bar\*

\$4000

The Library Bar is located on the rooftop of the historic Mitchell Building, includes indoor and outdoor space and features unique views across to the Harbour and city skyline.

The Library Bar is available for private hire outside of bar opening hours.

## Capacity

licensed for 120

## Includes

- bar furniture
- microphone
- sound system

*\* conditions apply*



# Catering

Laissez-Faire Catering pride themselves on providing an extraordinary experience through the quality of their cuisine, legendary service and attention to every detail.

With over 30 years catering experience, both in-house and offsite, they produce and deliver high-end, large and boutique scale events. They source fresh, local seasonal produce, create innovative menus, provide you with superior service and full-time event catering support.

Please contact Laissez-Faire Catering directly and their friendly staff will assist you in arranging all your catering needs.



## **Laissez-Faire Catering**

30 Birmingham Street  
Alexandria NSW 2015  
(02) 9209 4810  
admin@laissez.com.au  
www.laissez.com.au





# STATE LIBRARY OF NSW VENUES

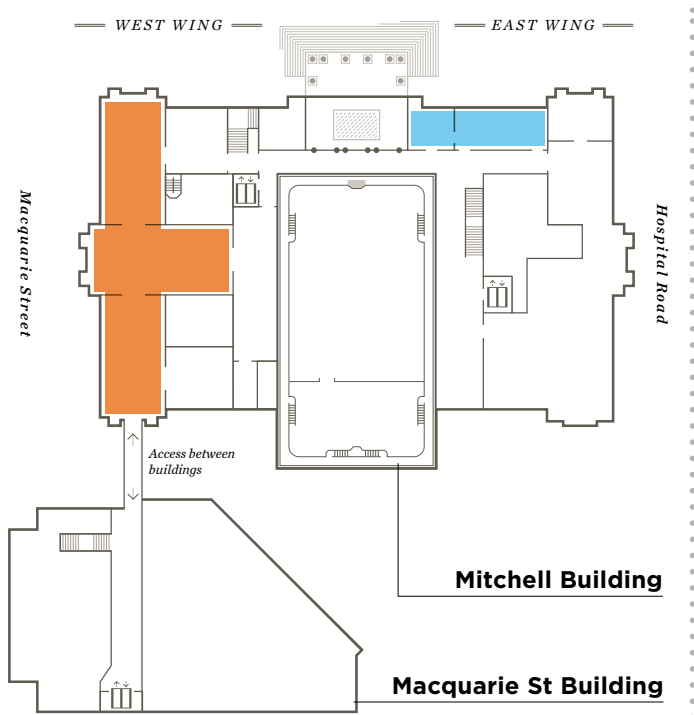

## LEVEL 1

- Map Rooms - The Michael Crouch Room
- Galleries - Paintings from the Collection

Mitchell Building

Macquarie St Building

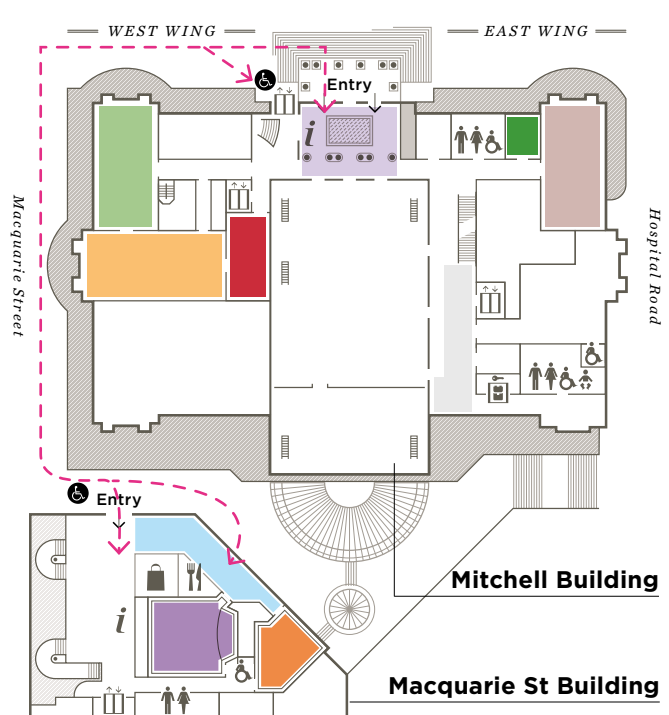

## GROUND LEVEL

---> Street entry

- Mitchell Vestibule
- Dixson Room
- Shakespeare Room
- Friends Room
- Gallery Room
- Jean Garling Room

Mitchell Building

- Metcalf Auditorium
  - Macquarie Room
  - Cafe
- Macquarie St Building

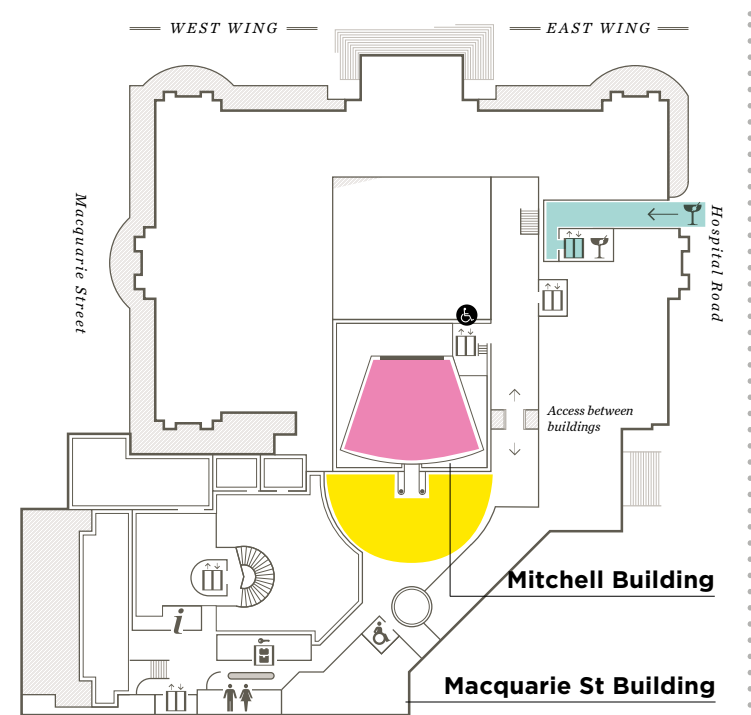

## LOWER GROUND 1

- Library Auditorium
- Library Bar (lift to rooftop)

Mitchell Building

- Glasshouse
- Macquarie St Building

- Information
- Lifts
- Toilets
- Baby change
- Lockers
- Accessible toilet





### Contact

Venue Hire, Visitor Services Branch  
State Library of NSW  
1 Shakespeare Place, Sydney NSW 2000  
(02) 9273 1744  
[venue.hire@sl.nsw.gov.au](mailto:venue.hire@sl.nsw.gov.au)  
[sl.nsw.gov.au](http://sl.nsw.gov.au)